

ПЕРЕКЛЮЧАТЕЛЬ КНОПОЧНЫЙ СЕРИИ PBS-12A

ON-OFF

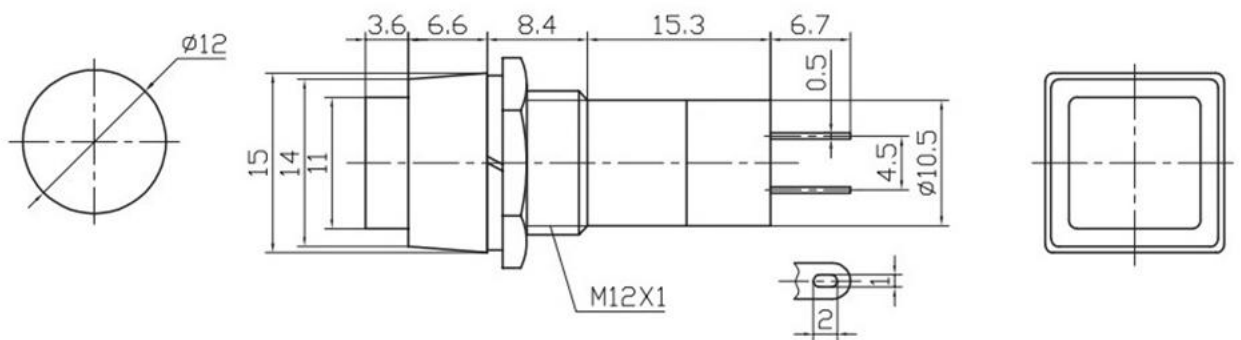

Ordering Information

PBS-10B-2

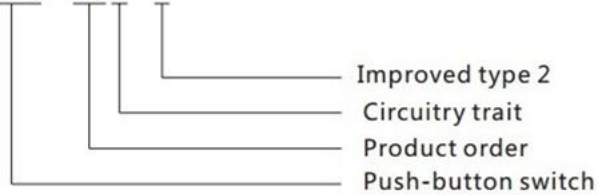

Improved type 2
Circuitry trait
Product order
Push-button switch

Specification

1. Rating: 3A 125VAC; 1A 250VAC
2. Contact Resistance: 20m Ω max
3. Insulation Resistance: 500VDC 100M Ω min
4. Dielectric Strength: 1000VAC, 1Minute
5. Operating Temperature: -25 $^{\circ}$ C ~ +85 $^{\circ}$ C
6. Electrical Life: 50,000 Cycles

Circuitry trait

A	ON - OFF	Push on/Push off	With lock
B	(ON) - OFF	Push on	Momentary(Open type)
C	ON - (OFF)	Push off	Momentary(Close type)
(): Indicates Momentary			