

Slide Switch

Q-2074

TYPE: **PBS-110B**



SPECIFICATIONS

Contact Type	DPDT
Pin Width	7 mm
Rating	AC 250V, 5A
Contacts Resistance	50mΩ
Insulation Resistance	1000MΩ
Minimum Load	DC 500V
Dielectric Strengths	AC 1500V / 1 minute
Life Test	10 000 cycles/ minute
Material	Plastic & Metal

Outline Drawing

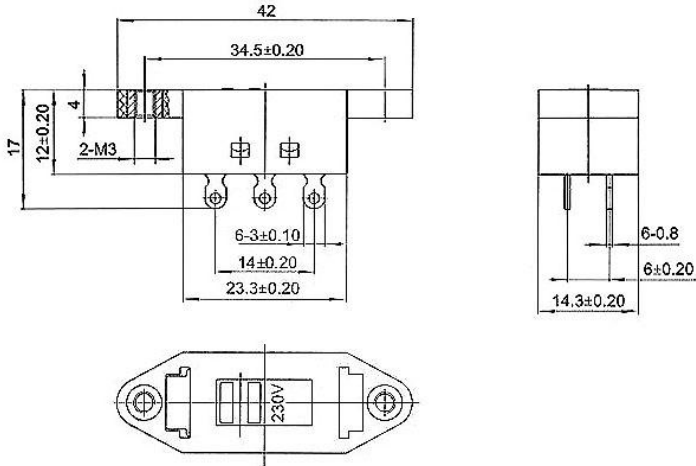

Mounting

Circuitry

