

# Tact Switch

**Q-2718**

TYPE: **SKEYAHA010**



## SPECIFICATIONS

Contact Type	SPST
Rating	DC 12V, 50mA
Contacts Resistance	500mΩ Max
Insulation Resistance	50MΩ Min
Minimum Load	DC 100V
Dielectric Strengths	AC 100V / 1 minute
Life Test	500 000 cycles/ minute
Operating temperature range	-40°C to +90°C

## Outline Drawing

Unit: mm

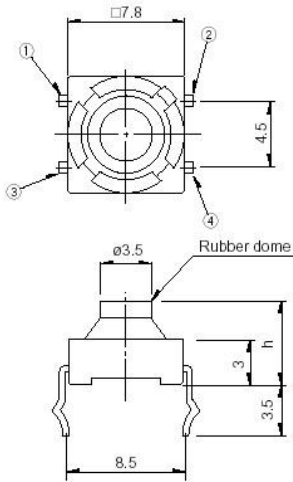

h
5

Mounting

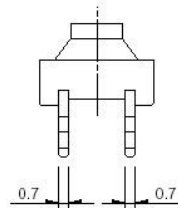

Circuitry

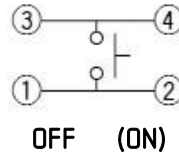
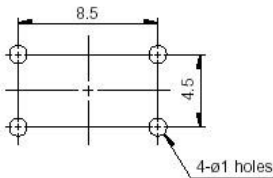



## SOLDERING CONDITIONS

### Conditions for Auto-dip

Items	Condition
Flux built-up	Mounting surface should not be exposed to flux
Preheating temperature	Ambient temperature of the soldered surface of PC board. 100°C max.
Preheating time	60s ax.
Soldering temperature	260°C max.
Duration of immersion	5s max.
Number of soldering	2times max.

### Manual Soldering

Items	Condition
Soldering temperature	350°C max.
Duration of soldering	3s max.
Capacity of soldering iron	60W max.

1. Consult with us for availability of TACT switch™ washing.
2. Prevent flux penetration from the top side of the TACT switch™.
3. Switch terminals and a PC board should not be coated with flux prior to soldering.
4. The second soldering should be done after the switch returns to normal temperature.
5. Use the flux with a specific gravity of at least 0.81.  
(EC-19s-8 by TAMURA Corporation, or their equivalents.)