

Data Sheet

Type Number 6032
Designation IEC CR 2032
System Li-Manganese dioxide / Organic Electrolyte

UL Recognition:..... MH 13654 (N)
Nominal Voltage 3 V
Typical Capacity C 230 mAh
 Load 5.6 kOhm, at 20°C down to 2 V

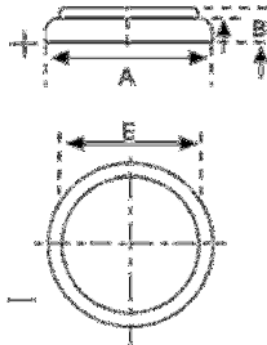

Weight (approx.) 3 g
Volume 0,95 ccm
Coding..... Date of Manufacturing Month / Year

Temperature Ranges

	min	max.
Storage	-55 °C	70 °C
Discharge	-20 °C	70 °C

Dimensions

	min	max.
Diameter (A)	19,7	20,0
Height (B)	2,9	3,2
Shoulder Diameter[E].....	16,0	

Segment Electronic

Main Applications Watch
 Photo
 Electronic

Typical Capacities (at 20 °C)

Discharge Type	Load	End Voltage:	2.0 V
Continuous 24h/d,7d/w Current [µA]:	5600 Ω	Time:	460 h
		Capacity [mAh]:	230
		Energy [mWh]:	645