



# ET24 EMI FILTER

## FWCMET24H SERIES

DIMENSIONS (mm)

Schematics

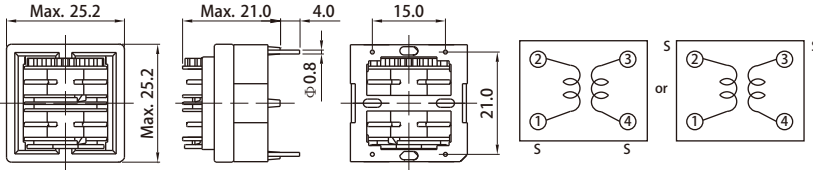

Ferriwo Part No.	Inductance (1-2) (4-3) @1kHz	Inductance Balance	D.C.R. (1-2) (4-3) @20°C	Rated Current (50/60Hz)
FWCMET24H252N	Min. 2.5mH	Max. 100μH	Max. 130mΩ	2.0Arms
FWCMET24H352N	Min. 3.5mH	Max. 150μH	Max. 180mΩ	1.7Arms
FWCMET24H452N	Min. 4.5mH	Max. 200μH	Max. 210mΩ	1.5Arms
FWCMET24H103N	Min. 10mH	Max. 300μH	Max. 470mΩ	1.0Arms
FWCMET24H153N	Min. 15mH	Max. 400μH	Max. 730mΩ	800mArms
FWCMET24H203N	Min. 20mH	Max. 600μH	Max. 870mΩ	700mArms
FWCMET24H353N	Min. 35mH	Max. 800μH	Max. 1.58Ω	600mArms

Impedance Characteristics

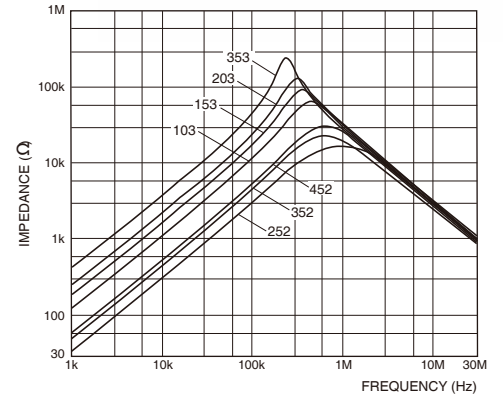

### Application

Noise prevention for TV, VCR, AV, OA devices.

### Features

1. Inexpensive type.
2. Large inductance is possible with closed magnetic core.

## FWCMET24V SERIES

DIMENSIONS (mm)

Schematics

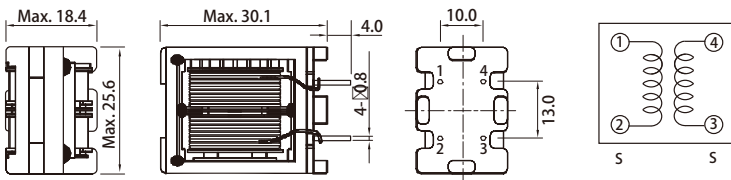

Ferriwo Part No.	Inductance (1-2) (4-3) @1kHz	D.C.R. (1-2) (4-3) @20°C	Rated Current (50/60Hz)
FWCMET24V222N	Min. 2.2mH	Max. 85mΩ	2.5Arms
FWCMET24V472N	Min. 4.7mH	Max. 170mΩ	1.7Arms
FWCMET24V103N	Min. 10.0mH	Max. 390mΩ	1.0Arms
FWCMET24V273N	Min. 27.0mH	Max. 1.0Ω	670mArms
FWCMET24V563N	Min. 56.0mH	Max. 1.95Ω	460mArms
FWCMET24V332N	Min. 3.3mH	Max. 85mΩ	2.5Arms
FWCMET24V682N	Min. 6.8mH	Max. 170mΩ	1.7Arms
FWCMET24V153N	Min. 15.0mH	Max. 390mΩ	1.0Arms
FWCMET24V393N	Min. 39.0mH	Max. 1.0Ω	670mArms
FWCMET24V683N	Min. 68.0mH	Max. 1.95Ω	460mArms
FWCMET24V392N	Min. 3.9mH	Max. 85mΩ	2.5Arms
FWCMET24V822N	Min. 8.2mH	Max. 170mΩ	1.7Arms
FWCMET24V203N	Min. 20.0mH	Max. 390mΩ	1.0Arms
FWCMET24V473N	Min. 47.0mH	Max. 1.0Ω	670mArms
FWCMET24V823N	Min. 82.0mH	Max. 1.95Ω	460mArms

Impedance Characteristics

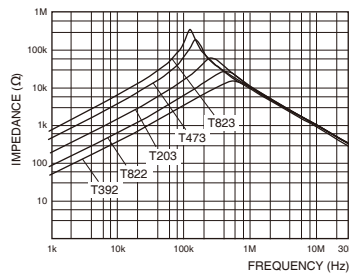
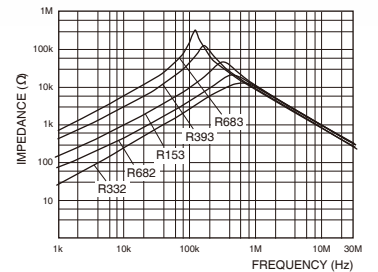
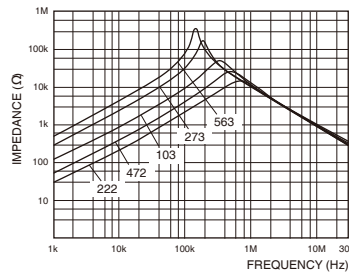

### Application

Noise prevention for TV, VCR, AV, OA equipments.

### Features

AC common mode choke coil which has excellent attenuation characteristics in low frequency band.