

DYNAMIC RECEIVER									
Series	Model	Diameter (mm)	Height (mm)	Impedance (Ω)	SPL (dB)	Input Power (mV)	Frame	Terminal	Page No.
J10A	J10A106032	10.0	2.4	32	106+/-3	1mW	ABS	PT	35
J13A	J13AJ092032	13.0	2.5	32	92+/-3	100	ABS	PD	35
J13B	J13BJ092032	13.0	2.5	32	92+/-3	100	ABS	PT	35
J13E	J13E114032	13.0	2.7	32	114+/-3	180	METAL	PD	36
J13D	J13D101032	13.0	3.0	32	101+/-3	100	METAL	PT	36
H13C	H13C104032	13.5	2.7	32	104+/-3	100	METAL	PD	36
J14BC	J14BC116032	13.5	4.5	32	116+/-3	1mW	ABS	PD	37
J15B	J15BJ096032	15.0	2.6	32	96+/-3	100	METAL	PD	37
J15A	J15AJ096032	15.0	2.7	32	96+/-3	100	ABS	PD	37
J15C	J15CJ095032	15.0	2.7	32	95+/-3	100	ABS	PT	38
H15F	H15F112032	15.0	3.3	32	112+/-3	350	METAL	PD	38
J15E	J15EC110032	15.0	4.3	32	110+/-3	1mW	METAL	PD	38
J20B	J20BJ097032	20.0	2.8	32	97+/-3	100	ABS	PD	39
J20C	J20CJ092150	20.0	3.3	150	92+/-3	100	ABS	PT	39
H20F	H20F110150	20.0	3.8	150	110+/-3	500	ABS	PD	39
J20A	J20A090150	20.0	4.0	150	90+/-3	60	ABS	PD	40
J23B	J23B093150	23.0	5.0	150	93+/-3	60	ABS	L	40
J25AJ	J25AJ090150	25.0	4.8	150	90+/-3	60	ABS	PD	40
H25A	H25AJ090150	25.0	4.8	150	90+/-3	60	ABS	PD	41
J28E	J28E100150	28.0	3.8	150	100+/-3	100	ABS	PD	41
J28C	J28C093150	28.0	7.0	150	93+/-3	60	ABS	PD	41
H28C	H28C093150	28.0	7.0	150	93+/-3	60	ABS	PD	42
H28D	H28DJ096150	28.0	7.0	150	96+/-2	100	ABS	P	42
J28A	J28A093150	28.0	7.3	150	93+/-3	60	ABS	L	42
H28A	H28A093150	28.0	7.3	150	93+/-3	60	ABS	L	43
J28B	J28B096150	28.0	7.5	150	96+/-3	100	ABS	PD	43
H29A	H29AJ097150	29.0	5.4	150	97+/-3	100	ABS	PD	43
J31A	J31A093150	31.0	11.0	150	93+/-3	60	ABS	PT	44
H31A	H31A093150	31.0	11.0	150	93+/-3	60	ABS	PT	44
H31B	H31B094130	31.0	11.0	130	94+/-3	60	ABS	PD	44
J31E	J31EJ096300	31.0	12.3	300	96+/-3	100	METAL	PT	45
J31F	J31FJ096300	31.0	12.3	300	96+/-3	100	METAL	PT	45
H31DJ	H31DJ096300	31.0	12.3	300	96+/-3	100	METAL	PT	45
H31C	H31C094300	31.0	14.0	300	94+/-2	60	METAL	PT	46
J35A	J35A110300	35.0	17.6	300	110+/-3	1mW	ABS	PT	46
J38B	J38B097150	38.0	18.8	150	97+/-3	60	ABS	PD	46
J38A	J38A096150	38.0	21.2	150	96+/-3	60	ABS	PT	47
H38A	H38A096150	38.0	21.2	150	96+/-3	60	ABS	PT	47
H45A	H45A113150	45.0	21.0	150	113+/-3	1mW	ABS	SPD	47

PIEZO RECEIVER									
Series	Model	Diameter (mm)	Height (mm)	Impedance (Ω)	SPL (dB)	Capacitance	Frame	Terminal	Page No.
DB-E1568	156PZ21100	21	2	2500 Max.	106+/-3	75 nF +/- 30 % at 120Hz	ABS	L	48
DB-E778	77PR23100	22.2	3.4	1200 Max.	110+/-3.5	90 nF +/- 30 % at 1KHz	ABS	L	48
DB-E808	80PR22100	22.2	3.8	2500 Max.	105+/-3	45 nF +/- 30 % at 1K Hz	ABS	P	48
DB-E828	82PR30100	30.4	5.7	2500 Max.	110+/-3	70 nF +/- 30 % at 1K Hz	ALUMINUM	PD	49
DB-E818	81PR33100	33.4	4.1	3000 Max.	107+/-3	40 nF +/- 30 % at 1K Hz	ALUMINUM	L	49

L - Leadwire, P - Pin, PT - Plate, SPD - Solder Pad

J38A



COLOUR	HOUSING	TERMINAL
IVORY	ABS	PLATE

FREQUENCY RESPONSE CURVE

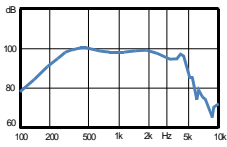

ELECTRICAL SPECIFICATIONS

Model No.	J38A096150
Sensitivity at 1 KHz. (IEC 318) (dB)	96 ± 3
Input at 1KHz (mV)	60
Frequency Range (Hz.)	300 - 4000
AC. Impedance at 1KHz. (Ω)	150 ± 20%
HAC Compatible	NIL
Weight (g)	36

DIMENSION

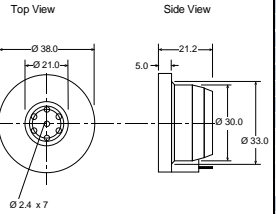

all dimensions are in mm

H38A



COLOUR	HOUSING	TERMINAL
IVORY	ABS	PLATE

FREQUENCY RESPONSE CURVE

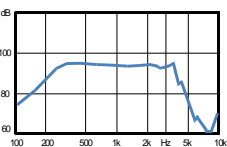

ELECTRICAL SPECIFICATIONS

Model No.	H38A096150
Sensitivity at 1 KHz. (IEC 318) (dB)	96 ± 3
Input at 1KHz (mV)	60
Frequency Range (Hz.)	300 - 4000
AC. Impedance at 1KHz. (Ω)	150 ± 20%
HAC Compatible	YES
Weight (g)	36

DIMENSION

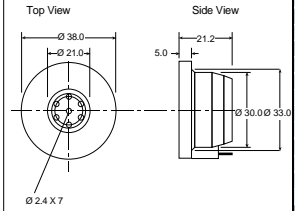

all dimensions are in mm

H45A



COLOUR	HOUSING	TERMINAL
IVORY	ABS	SCREW SOLDER PAD

FREQUENCY RESPONSE CURVE

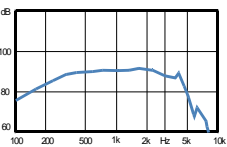

ELECTRICAL SPECIFICATIONS

Model No.	H45A113150
Sensitivity at 1 KHz. (IEC 318) (dB)	113 ± 3
Input at 1KHz (mV)	1
Frequency Range (Hz.)	300 - 4000
AC. Impedance at 1KHz. (Ω)	150 ± 20%
HAC Compatible	YES
Weight (g)	70

DIMENSION

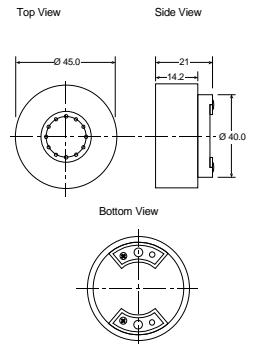

all dimensions are in mm