

# SPECIFICATION

- 1. Rated Voltage ..... 6VDC
- 2. Operating Voltage ..... 4~8VDC
- 3. Max. Rated Current ..... 25mA at 6VDC
- 4. Resonant Frequency ..... 400±100Hz
- 5. Min. Sound Pressure Level..... 75dB at 6VDC/20cm
- 6. Response Time..... ≤50ms
- 7. Case Material ..... ABS
- 8. Operating Temperature ..... -20~+60℃
- 9. Store Temperature ..... -30~+70℃
- 10. Weight ..... 10g

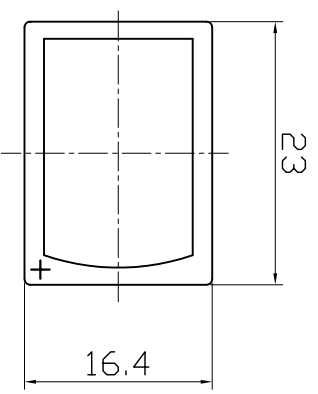

|                         |  |             |  |   |  |      |  |
|-------------------------|--|-------------|--|---|--|------|--|
|                         |  |             |  |   |  |      |  |
|                         |  |             |  | <b>KEPO</b> NINGBO KEEP IMPROVING ELECTRONIC CO.,LTD<br><a href="http://www.chinaacoustic.com">http://www.chinaacoustic.com</a> |  |      |  |
| No.                     |  | DESCRIPTION |  | APPROVED  |  | DATE |  |
| TOLERANCES: MILLIMETERS |  | APPROVALS   |  | DRAWN   |  | DATE |  |
| FRACTIONAL DECIMALS     |  | DRAWN       |  | CHECKED   |  | DATE |  |
| XXX ±                   |  | DRAWN       |  | APPROVED  |  | DATE |  |
| XXX ±                   |  | DRAWN       |  | APPROVED  |  | DATE |  |
| 90° ANGLES ±°           |  | DRAWN       |  | APPROVED  |  | DATE |  |
| FIRST ANGLE PROJECTION  |  | DRAWN       |  | APPROVED  |  | DATE |  |
|                         |  | DRAWN       |  | APPROVED  |  | DATE |  |
| UNIT                    |  | DWG NO.     |  | SHEET   |  | VER. |  |
| mm                      |  | KP3.840.614 |  | 1   |  | 1.1  |  |

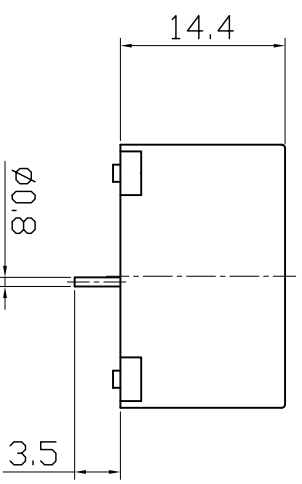
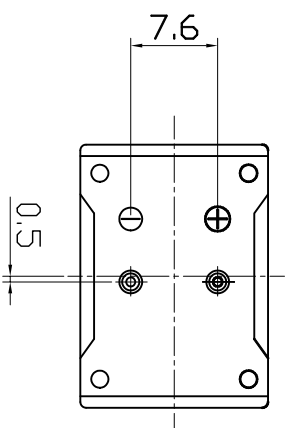